

Soils Map

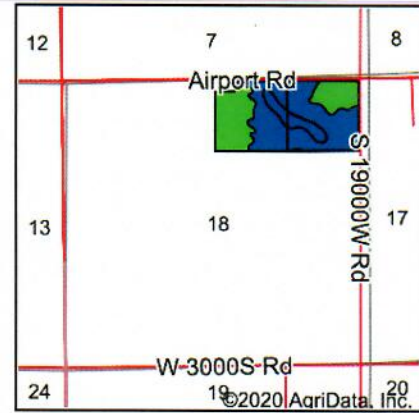

State: **Illinois**
 County: **Kankakee**
 Location: **18-30N-9E**
 Township: **Norton**
 Acres: **78.11**
 Date: **9/21/2020**

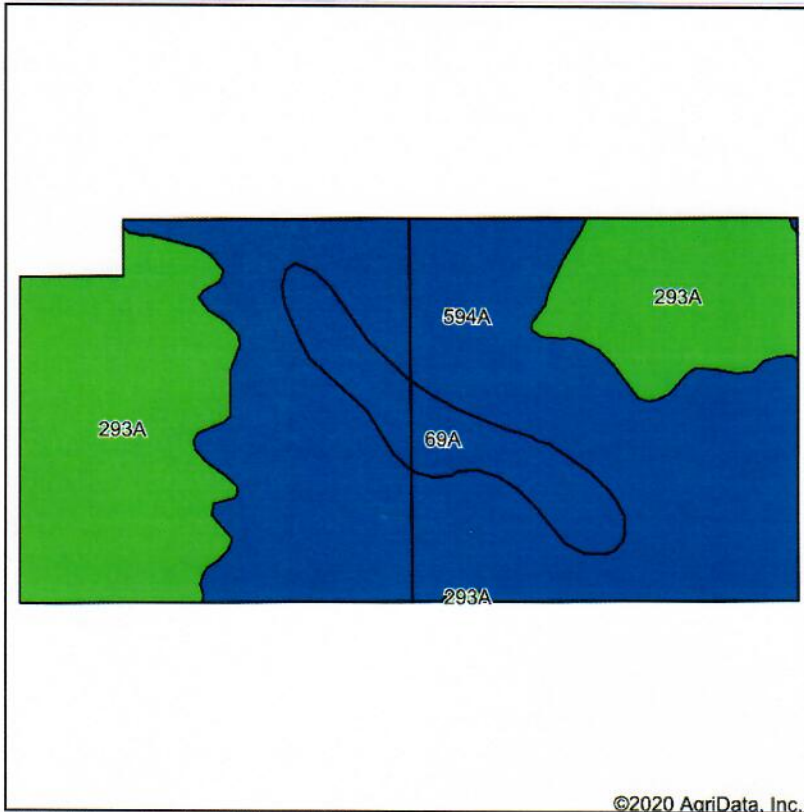

Soils data provided by USDA and NRCS.

©2020 AgriData, Inc.

Area Symbol: IL091, Soil Area Version: 17							
Code	Soil Description	Acres	Percent of field	Il. State Productivity Index Legend	Corn Bu/A	Soybeans Bu/A	Crop productivity index for optimum management
594A	Reddick clay loam, 0 to 2 percent slopes	43.53	55.7%		177	56	130
293A	Andres silt loam, 0 to 2 percent slopes	27.98	35.8%		184	59	135
69A	Milford silty clay loam, 0 to 2 percent slopes	6.60	8.4%		171	57	128
Weighted Average					179	57.2	131.6

Table: Optimum Crop Productivity Ratings for Illinois Soil by K.R. Olson and J.M. Lang, Office of Research, ACES, University of Illinois at Champaign-Urbana. Version: 1/2/2012 Amended Table S2 B811

Crop yields and productivity indices for optimum management (B811) are maintained at the following NRES web site:
<http://soilproductivity.nres.illinois.edu/>

** Indexes adjusted for slope and erosion according to Bulletin 811 Table S3
 *c: Using Capabilities Class Dominant Condition Aggregation Method

Soils data provided by USDA and NRCS. Soils data provided by University of Illinois at Champaign-Urbana.