

WASSUM LAND AUCTION

28.136 ACRES | TUSCARAWAS COUNTY

THURSDAY, JULY 11, 2019 – 6:00 PM



Kaufman

Realty & Auctions

888.852.4111

www.kaufmanauction.sale

PO Box 422, Sugarcreek, Ohio 44681



WASSUM LAND AUCTION

28.136 ACRES | TUSCARAWAS COUNTY

THURSDAY, JULY 11, 2019 – 6:00 PM

Broad Run Dairy Rd.

DOVER, OHIO

Tuscarawas County

GPS Coordinates: 40.538391, -81.560919



Directions: From Winfield take Broad Run Dairy Rd south approx. 1 mile to location, or from SR 39 east of Sugarcreek take Pysi Rd NW to Broad Run Dairy Rd to location. Signs Posted.



Features: 28.136 Acres, Dover Twp., Tuscarawas County, 1 Parcel, Beautiful Building Site w/Amazing Views

28+ Acre building lot for the home of your dreams. There is enough land for a beautiful gentleman's farm. Walk this land at your own risk-convenience. Use the grass strip to drive up to your future home site.

Real Estate Terms: 10% nonrefundable down payment day of sale with the balance due at closing. No financing or other contingencies, property sells "AS IS". Any required inspections must be completed prior to bidding. Sellers to transfer any and all owned mineral rights. Property sells subject to all articles of record. Announcements day of sale take precedence over all previous advertising and statements.

Legal: Parcel #10-01180-001 in Dover Twp. Of Tuscarawas County in the Dover City SD. Taxes are currently \$168.18/per year

Auction by order of: Daniel & Felicia Wassum

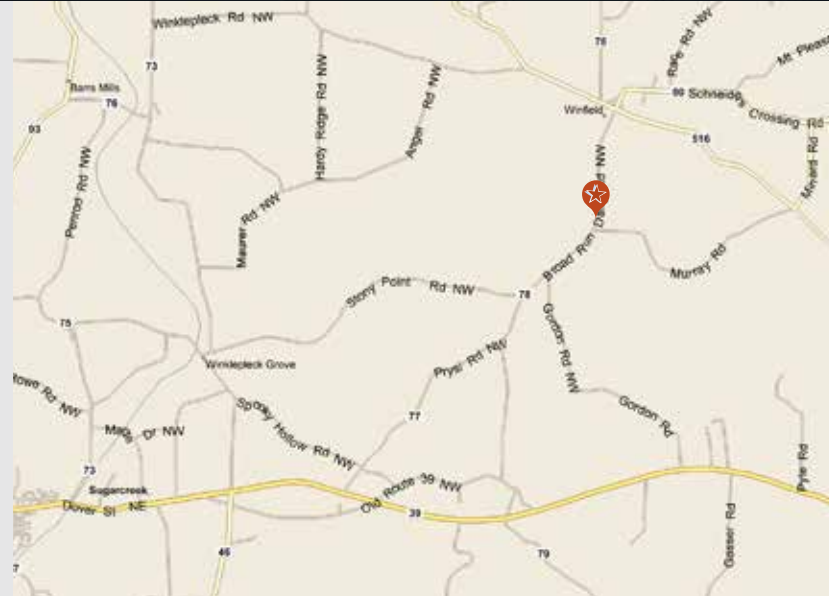

Kaufman
Realty & Auctions

888.852.4111 | KaufmanAuction.sale

Derrick Kandel | Realtor, Auctioneer
330.231.4524 | derrick@kaufmanrealty.com